

# TABLE OF CONTENTS

**FUEL, ENGINE OIL AND COOLANT RECOMMENDATIONS**

**1**

**CONTROLS, EQUIPMENT AND ADJUSTMENTS**

**2**

**RIDING YOUR ATV**

**3**

**ACCESSORY USE AND VEHICLE LOADING**

**4**

**INSPECTION AND MAINTENANCE**

**5**

**TROUBLESHOOTING**

**6**

**PREPARATION FOR WINTER RIDING**

**7**

**TRANSPORTING**

**8**

**CLEANING PROCEDURE**

**9**

**CONSUMER INFORMATION**

**10**

**SPECIFICATIONS**

**INDEX**

## LEFT HANDLEBAR

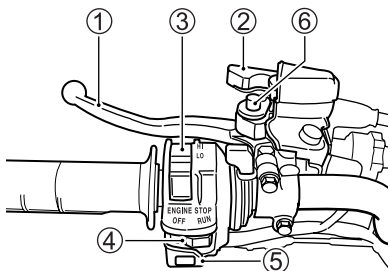

### Clutch Lever ①

The clutch lever is used for disengaging the drive to the rear wheels when starting the engine or shifting transmission gears. Squeezing the lever disengages the clutch.

### Parking Brake Lock ②

Use this lock to set and lock the parking brake. Use the parking brake to help prevent the ATV from moving when it is parked, being started, or at idle. To lock the parking brake, push the knob ⑥, squeeze the clutch lever and engage this lock. To release the parking brake, squeeze the clutch lever and release the parking brake lock ②.

### Dimmer Switch ③

Use the dimmer switch to select the high or low headlight beam when the ignition switch is in the "☀️ (LIGHTS)" position. When you move the dimmer switch to the "HI" position, the high beam will light and the high beam indicator light will come on. When you move the dimmer switch to the "LO" position, the low beam will light.

## CAUTION

Improper dimmer switch operation can damage the ATV.

Holding the dimmer switch between "HI" and "LO" position will light both "HI" and "LO" headlight beam. This operation can damage the ATV.

Use the dimmer switch only at "HI" or "LO" position.

## SPARK PLUG

Your ATV comes equipped with an NGK CR8EB spark plug. To determine if the standard spark plug is right for your usage, check the color of the plug's porcelain center electrode insulator after vehicle operation. A light brown color indicates that the plug is correct. A white or dark insulator indicates that the engine may need adjustment, or another plug type may be needed. Consult your Suzuki dealer if your plug insulator is not a light brown color.

### CAUTION

Failure to use the proper spark plug can be hazardous.

An improper spark plug may have an incorrect fit or heat range for your engine. This may cause severe engine damage which may not be covered under warranty.

Use one of the spark plugs listed below or equivalent. Consult your Suzuki dealer if you are not sure which spark plug is correct for your type of vehicle usage.

NGK	REMARKS
CR7EB	If the standard plug tends to run cold.
CR8EB	Standard
CR9EB	If the standard plug tends to run hot.

*NOTE: If the above-named plugs are not available, consult your Suzuki dealer.*

## SPARK PLUG REMOVAL

1. Remove the seat by referring to the SEAT LOCK section.

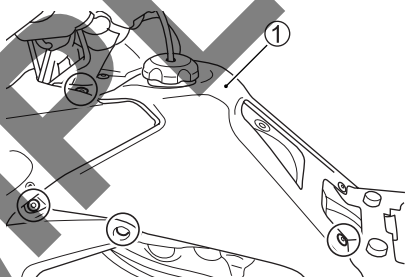

2. Remove the right and left fasteners. Open the fuel tank cap. Remove the fuel tank cover ①.

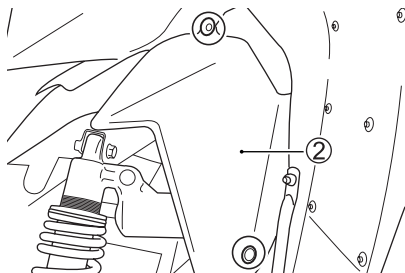

3. Remove the fasteners and cover ②.